



Quick Mount PV[®]

RESPECT THE ROOF[®]

The industry standard for 100% code-compliant,
waterproof solar roof mounts

- Residential & Commercial
- Low Slope & Steep Slope
- New Roofs & Retrofit



BORN IN THE TRADES

Quick Mount PV manufactures innovative waterproof mounting systems designed to meet the needs and demands of rooftop solar systems – the need for fast installation of multiple mounts, and the demand that each and every roof attachment be strong and absolutely watertight. Having pioneered the use of roofing industry best practices in the solar industry, Quick Mount PV is the recognized industry standard for solar roof mounts.

Committed to the Future of Solar Power

Prior to founding Quick Mount PV, Stuart and Claudia Wentworth spent 20 years in the metal fabrication, green building, and construction trades. As solar PV installers for seven years before launching the company, the Wentworths saw far too many mounting methods in use that were doomed to failure in the long run, posing a threat to the burgeoning solar P V industry.

In 2006, with a passion for solar energy and a deep commitment to doing solar right, the Wentworths founded Quick Mount PV to bring fast, cost-effective, and 100% code-compliant waterproof mounting systems to the solar industry.



Co-founders Stuart and Claudia Wentworth combined their construction and metal fabrication expertise with their passion for solar to found Quick Mount PV.

Supplying a Growing Demand

Quick Mount PV's first products were designed for retrofitting solar installations onto steep-slope residential rooftops. Our composition, tile and shake mounts became an instant hit in a market hungry for quality mounting solutions. In 2011, the company introduced solar mounts for two new markets: one for commercial low slope roofs, and another for new home construction and roof replacement.



All Quick Mount PV products are designed, engineered, fabricated, warehoused and sold by the company's dedicated and multi-skilled staff at its northern California headquarters.

The company has grown at 70+ percent per year to meet rapidly rising demand. Quick Mount PV currently employs 62 people in its northern California headquarters, where it fabricates all company products. Quick Mount PV is committed to ongoing product innovation to successfully address the full range of roofing environments and continually perfect the art of rooftop solar mounting.

PRODUCT OVERVIEW

PRODUCT FAMILY	Applicable Roof Types	New Roof	Retrofit	Flashing Included	Hardware Included *	# of Roof Attachments
Classic Comp & Shake pg 3	 QMSC & QMLC	composition shingle, shake		✓	✓	1
Low Slope pg 4	 QMLSH	PVC, TPO, EPDM & built-up roofs	✓	✓	**	2 or 4
New Roof Comp pg 5	 QMNC	composition shingle	✓	***	✓	2 or 4
Universal Tile pg 6	 QMUTM	curved or flat tile	✓	✓	✓	2 or 4

* All exposed hardware is 18-8 stainless steel.
** The Low Slope Mount is sold without flashing. For use on built-up asphalt roofs, aluminum flashing is available seperately from Quick Mount.
*** The New Roof Comp Mount can also be used for retrofit when two points of attachment are required.

WARNING: Quick Mount PV products are NOT designed and should NOT be used to anchor fall protection equipment.

Show Your Customers You Use the Very Best

Use our **Quick Mount Seal** to help “seal the deal” with your sales prospects. Place the seal in your ads, on your website, and in your sales literature to show you care enough to use the industry standard in waterproof flashed mounts to protect your customers' roofs. Contact us to get the Quick Mount Seal in the sizes and formats to meet your needs.



CLASSIC COMP/SHAKE

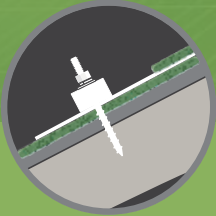

QMSC & QMLC

- ✓ Residential
- ✓ Retrofit
- ✓ Steep slope
- ✓ Composition shingle roofs
- ✓ Shake roofs

Superior Waterproofing Technology

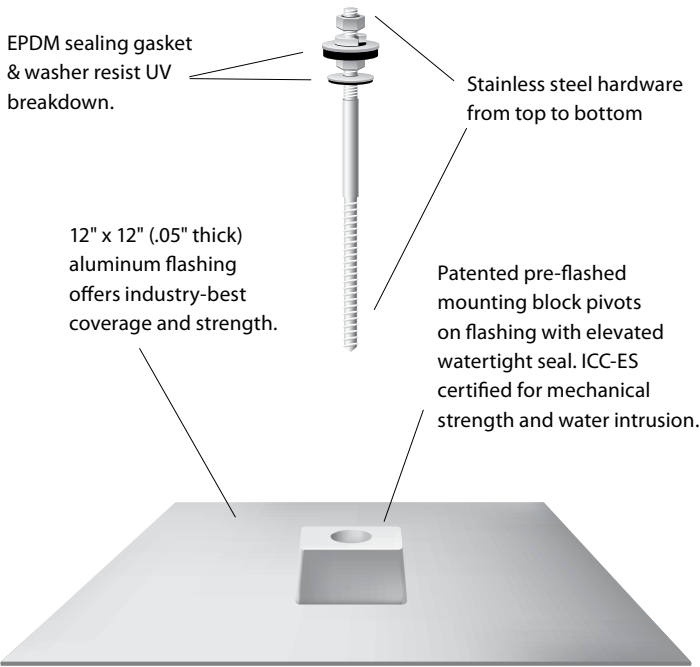

Ideal for Solar Hot Water



The same qualities of strength and durability that make our Classic Comp & Shake Mounts the best choice for PV also make them perfect for solar hot water systems.

Our Classic Comp & Shake Mounts are the recognized industry standard for off-the-shelf, code compliant, waterproof mounts, and the fastest to install on existing composition shingle and shake roofs.



FEATURES

- ▶ Patented elevated water seal
- ▶ ICC-ES certified
- ▶ One-bolt installation
- ▶ No shingle cutting
- ▶ 100% IBC compliant
- ▶ Meets or exceeds all roofing industry best practices
- ▶ 2554 lbs. average pullout (Douglas fir); 2203 lbs. average shear (see engineering report at quickmountpv.com)
- ▶ All aluminum flashing and mount
- ▶ All hardware included; all exposed hardware is 18-8 stainless steel
- ▶ 10-year warranty; 50-year expected life
- ▶ Works with all leading racks
- ▶ Won't void roof manufacturer's warranty
- ▶ Approved for use by leading roof manufacturers
- ▶ Patent numbers 7,762,027 & 7,895,808



EACH MOUNT KIT (12 per box) includes:

- ▶ Cast aluminum mounting block (2¼" L x 1¼" W x 1¼" H) bonded with .05" thick, 12" x 12" aluminum flashing. 18" x 18" in Shake Roof version.
- ▶ Hanger bolt, ⅝" x 6" (1¼" machine, 1¾" shank, 3" lag) (⅜" hanger bolt also available for solar hot water or PV systems)
- ▶ EPDM-bonded stainless steel sealing washer, ⅝" x ¾"
- ▶ Two stainless steel hex nuts, ⅝"
- ▶ EPDM sealing gasket with 60 Durometer hardness
- ▶ Stainless steel fender washer
- ▶ Stainless steel split lock washer, ⅝"



Available finishes (both Comp and Shake): aluminum mill (A), clear anodized (C), bronze anodized (B)

LOW SLOPE

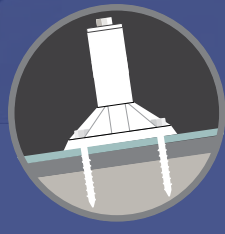

QMLSH

- ✓ Commercial
- ✓ New roof
- ✓ Retrofit
- ✓ Low slope
- ✓ TPO, PVC, EPDM roofs
- ✓ Built-up roofs

Quick Mount's Low Slope Mount takes the traditional base-and-post mount to its ultimate level. It's the strongest you can buy for mechanically attaching commercial PV systems to TPO, PVC, EPDM, built-up asphalt, and virtually all other non-metal low slope roofs.



Low Slope Mount on a TPO membrane roof

FEATURES

- ▶ Code compliant for all non-metal low slope roofs
- ▶ QBase is the strongest off-the-shelf mechanical mount
- ▶ 3031 lbs. average pullout (Douglas fir) (see engineering report at quickmountpv.com)
- ▶ All exposed hardware is 18-8 stainless steel
- ▶ 3 post heights offer 7", 9" and 12" clearance off the deck
- ▶ Attaches to roof structure with 2 or 4 fasteners
- ▶ All fasteners and related hardware included
- ▶ Mount entire solar array or secure ballasted system from shifting
- ▶ 100% IBC compliant
- ▶ Meets or exceeds all roofing industry best practices
- ▶ 10-year warranty; 50-year expected life
- ▶ Works with all leading racks
- ▶ Patents pending

EACH MOUNT KIT (12 per box) includes:

- ▶ Cast aluminum QBase
- ▶ Two zinc-coated steel lag bolts, 5/16" x 3"
- ▶ Aluminum post, 1.25" x 6.5", 8.5" or 11.5"
- ▶ EPDM-bonded stainless steel sealing washer, 5/16" x 1 1/4"
- ▶ Stainless steel machine bolt, 5/16" x 1"
- ▶ Stainless steel fender washer
- ▶ Stainless steel split lock washer, 5/16"
- ▶ Grade-8 machine bolt, 5/16" x 3/4"

Available finishes for post: aluminum mill (A), clear anodized (C), bronze anodized (B)



The unprecedented strength of the QBase enables low-slope roof standoffs up to 12 inches with industry-best shear strength. See quickmountpv.com for full engineering reports.

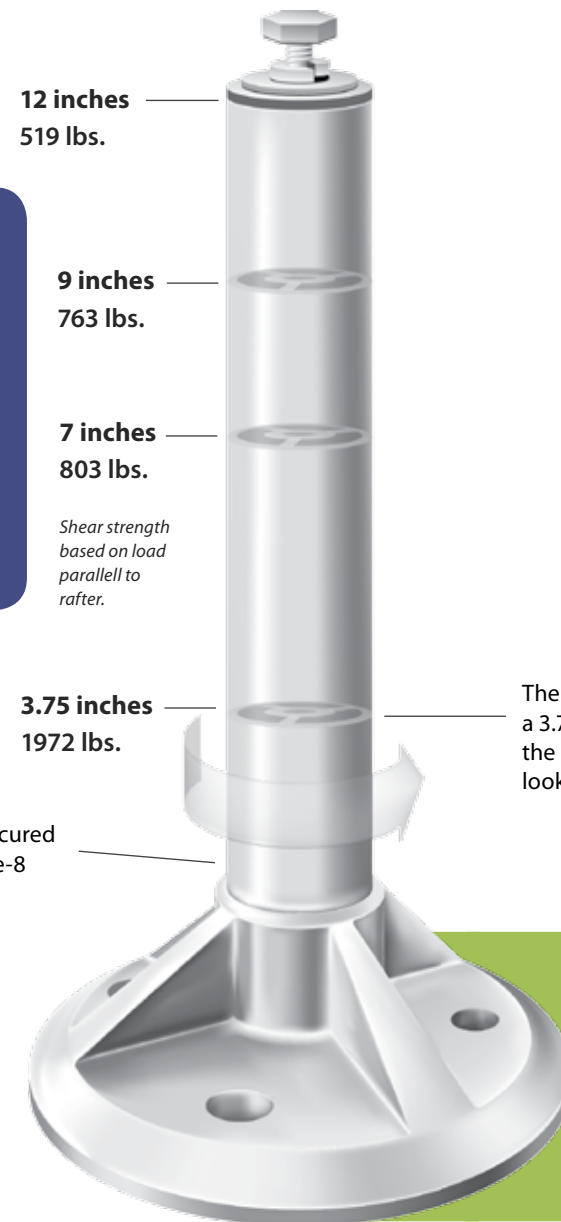

12 inches
519 lbs.

9 inches
763 lbs.

7 inches
803 lbs.

Shear strength
based on load
parallel to
rafter.

3.75 inches
1972 lbs.

Detachable post is secured to QBase with a grade-8 machine bolt.

EASY AS 1, 2, 3!

Integrating solar with the construction of a new roof is a great idea, but making the installation smooth and cost effective requires a coordinated effort between the various trades who help put the PV system on the roof. The New Roof Comp Mount installs in 3 steps to facilitate the workflow between the trades.

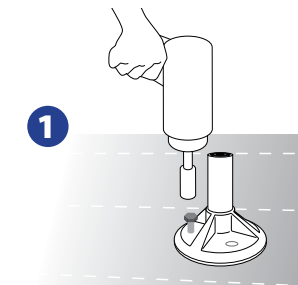

1
Mount the QBase and post after the sheeting is nailed down...

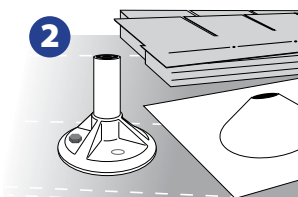

2
... leave the flashing for the roofers to install with the roof...

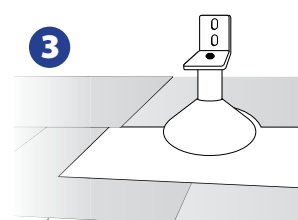

3
...then install the array after the roofing is finished!

QBase: Where the Roof Meets the Load

Our Low Slope, New Roof Comp, and Universal Tile Mounts are built around the all-aluminum QBase. With four buttresses to support the load, QBase makes these solar mounts the world's strongest - by far.

NEW ROOF COMP

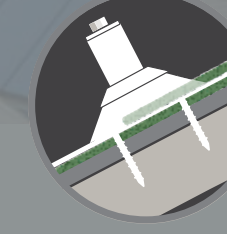

QMNC

- ✓ Residential
- ✓ New roof
- ✓ Retrofit
- ✓ Steep slope
- ✓ Composition shingle roofs

Quick Mount's New Roof Composition Mount is designed to smoothly fit into the workflow between the trades while installing solar arrays during new home construction or roof replacement.



FEATURES

- ▶ 3-step process aids installation collaboration between roofers and PV installers
- ▶ Cone flashing is spun aluminum with no welds or seams to rust or rot
- ▶ Flashing holds firm against wind-driven rain
- ▶ QBase is the strongest off-the shelf mechanical mount
- ▶ 3031 lbs. average pull out (douglas fir); 1972 lbs. average shear (see engineering reports at quickmountpv.com)
- ▶ All hardware included
- ▶ All exposed hardware is 18-8 stainless steel
- ▶ Allows up to 4 structural attachments for retrofit installations where multiple attachments are required
- ▶ EPDM post collar/counter flashing fits tight without sealant
- ▶ 100% IBC compliant
- ▶ Meets or exceeds all roofing industry best practices
- ▶ 10-year warranty; 50-year expected life
- ▶ Works with all leading racks
- ▶ Patents pending

EACH MOUNT KIT (12 per box) includes:

- ▶ Cast aluminum QBase
- ▶ Aluminum post, 1.25" x 3.25"
- ▶ 12" x 12" spun aluminum cone flashing
- ▶ Two zinc-coated steel lag bolts, 5/16" x 3"
- ▶ EPDM post collar/counter flash
- ▶ EPDM-bonded stainless steel sealing washer, 5/16" x 1 1/4"
- ▶ Stainless steel machine bolt, 5/16" x 1"
- ▶ Stainless steel fender washer
- ▶ Stainless steel split lock washer, 5/16"
- ▶ Grade-8 machine bolt, 5/16" x 3/4"

Available finishes: aluminum mill (A), bronze anodized (B)

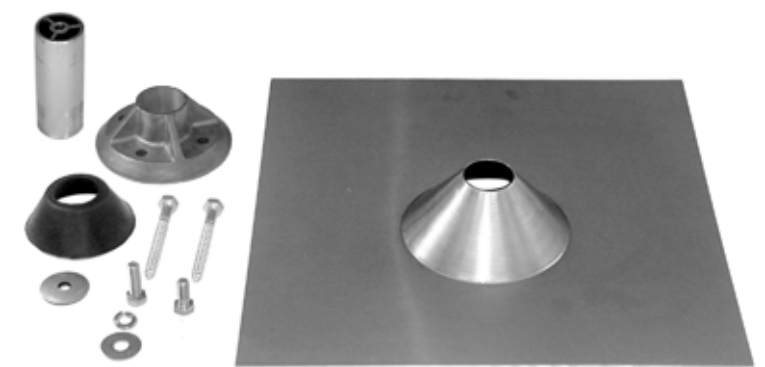

UNIVERSAL TILE

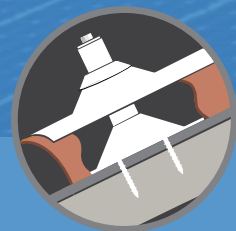

QMUTM

- ✓ Residential
- ✓ New roof
- ✓ Retrofit
- ✓ Steep slope
- ✓ Curved & flat tile roofs

The Quick Mount PV Universal Tile Mount is double flashed. The secondary top flashing is malleable, so it works equally well for both curved and flat tile roofs. Both flashings feature a spun aluminum cone, with no seams to fail in extreme weather. The reinforced QBase makes for an extraordinarily strong foundation. Ideal for both retrofit and new roof installations.



FEATURES

- ▶ Flashes all tile roofs, curved or flat
- ▶ Flashed at both the deck and tile level
- ▶ Large malleable aluminum top flashing
- ▶ QBase is the strongest off-the-shelf mechanical mount
- ▶ 3031 lbs. average pullout (Douglas fir); 803 lbs. average shear (see engineering report at quickmountpv.com)
- ▶ All fasteners and hardware included
- ▶ All exposed hardware is 18-8 stainless steel
- ▶ Attaches to roof structure with 2 or 4 fasteners
- ▶ 100% IBC compliant

The Universal Tile Mount uses the QBase foundation and two spun aluminum cone flashings to keep out the rain. The malleable top flashing conforms to fit virtually any tile roof. And the primary flashing at the roof deck forms a waterproof shield isolating all penetrating fasteners from corrosive water intrusion.

- ▶ Meets or exceeds all roofing industry best practices
- ▶ 10-year warranty; 50-year expected life
- ▶ Works with all leading racks
- ▶ Patents pending

EACH MOUNT KIT (12 per box) includes:

- ▶ Cast aluminum QBase
- ▶ Aluminum post, 1.25" x 6.5"
- ▶ 9" x 9" spun aluminum cone sub-flashing
- ▶ 18" x 18" spun aluminum cone malleable top flashing
- ▶ Two zinc-coated steel lag bolts, 5/16" x 3"
- ▶ Stainless steel machine bolt, 5/16" x 1"
- ▶ EPDM post collar/counter flash
- ▶ EPDM-bonded stainless steel sealing washer, 5/16" x 1 1/4"
- ▶ Stainless steel fender washer
- ▶ Stainless steel split lock washer, 5/16"
- ▶ Grade-8 machine bolt, 5/16" x 3/4"

Available finishes: aluminum mill (A), bronze anodized (B)



SPECIALTY MOUNTS

SPECIALTY FLAT TILE MOUNT | QMFTM

Quick Mount PV's Specialty Flat Tile Mount is an easy to use, double-flashed, standoff-and-base mounting assembly for most standard flat concrete tile roofs. A pre-formed spun-aluminum top flashing completely replaces a standard 12" x 17" interlocking concrete tile. There's no drilling or cutting the tiles. At the roof deck, a 9.5" x 10" spun aluminum primary flashing is designed to seal out water intrusion and is molded to shield the base plate and fasteners from water. All mounting hardware included; all exposed hardware is 18-8 stainless steel. *Patent number 7,861,485.*



EACH MOUNT KIT (12 per box) includes:

- ▶ Cast aluminum base plate, 5.5" x 3.5" x 0.5"
- ▶ 9.5" x 10" spun aluminum primary flashing
- ▶ 12" x 17" fitted aluminum top flashing
- ▶ 1.25" x 5.5" extruded aluminum post
- ▶ Grade-8 machine bolt, 5/16" x 3/4"
- ▶ Stainless steel machine bolt, 5/16" x 1"
- ▶ Four zinc-coated steel lag bolts, 1/4" x 1 1/2"
- ▶ EPDM rubber counter flash
- ▶ EPDM-bonded stainless steel sealing washer, 5/16" x 1 1/4"
- ▶ Stainless steel fender washer
- ▶ Stainless steel split lock washer, 5/16"

Available finishes: aluminum mill (A), clear anodized (C), bronze anodized (B)



CONDUIT MOUNT | QMCC

The Conduit Mount lifts conduit off the roof to protect wiring from overheating. These mounts use our patented elevated seal waterproofing technology to protect the roof penetration, and aluminum and stainless steel parts to secure the conduit for the life of the system. Available for composition and wood shake roofs.

Conduit Mounts measure 9" x 12". The mount uses a standard single-hole conduit clamp for half-inch through 1.5-inch conduits. Mounting hardware included; conduit clamp not included.

Available finishes: aluminum mill (A), clear anodized (C), bronze anodized (B)

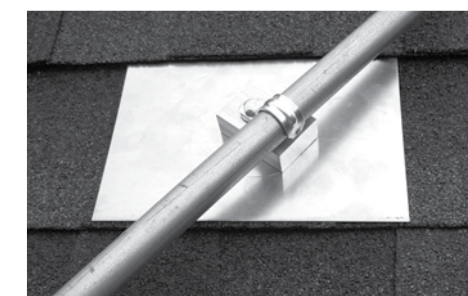

POOL PANEL MOUNT | QMPM

The Pool Panel Mount works with all strap-down pool panels. These flashed mounts seal out the rain and secure the solar collector to the roof. Anchor the waterproof Quick Mounts to the roof on either side of the collector and use flat rope straps (not included) to hold it securely in the wind.

Quick Mount PV's Pool Panel Mounts work with composition shingles and wood shake roofing. All hardware and butterfly clip included.

Available finishes: aluminum mill (A), clear anodized (C), bronze anodized (B)



TOOLS & ACCESSORIES

Dasco Pro 24" Shingle Ripper

The Dasco Pro 24" shingle ripper helps make your installations faster and more efficient. The tapered steel handle won't damage removed shingle or surrounding pieces. Removes all types of shingles.

- QMRB 1: 24" shingle ripper



Extensions

Use these aluminum extensions with our Classic Composition and Shake Mounts to add height when needed between the modules and the roof. The extensions are available in 2½, 3¼, and 4-inch lengths. 12 extensions per pack.

- QMEXT-2.5: (12) 2½" extensions with hardware
- QMEXT-3.25: (12) 3¼" extensions with hardware
- QMEXT-4.0: (12) 4" extensions with hardware



Available finishes: aluminum mill (A), clear anodized (C), bronze anodized (B)

Aluminum Flashing for Low Slope Mounts

For built-up asphalt roofs (BUR) and other bitumen and modified bitumen roofs, we offer aluminum flashings in 4" and 8" tall cones (not included with Low Slope Mount kit).

- QMLSF-4: (12) 4" Aluminum flashing cones
- QMLSF-8: (12) 8" Aluminum flashing cones

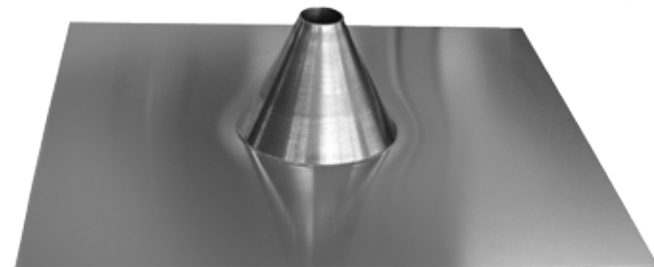

Hardware Sets

We offer additional hanger bolts in lengths of 6, 8, 10 and 12 inches. To maintain pull out and shear strength, only the shank of the hanger bolt is lengthened to help span insulation, fire-board, and other rooftop layers. Custom lengths are available upon request. 12 bolts per pack.

- QMHS-6: (12) 6" stainless steel hanger bolts with nuts & washers
- QMHS-8: (12) 8" stainless steel hanger bolts with nuts & washers
- QMHS-10: (12) 10" stainless steel hanger bolts with nuts & washers
- QMHS-12: (12) 12" stainless steel hanger bolts with nuts & washers



Training Bolts

We also offer 6" hanger bolts for training, with a fixed bottom nut enabling repeated insertion and removal.

- QM-ACC: (12) 6" training bolts (not shown)

Adapter & Sockets

These ½" and 7/16" 12-point sockets work with a 3/8" driver.

- QMSA-.375 1: Socket adapter
- QMDS-.50 1: Deep socket, ½"
- QMDS-.4375 1: Deep socket, 7/16"



Torque Wrench

- QMTW 1: Torque wrench



ARE YOU UP TO CODE?

As a solar installer, understanding the relationship between code makers, code enforcers and the installer gives you a leg up on what your building department expects. This can be the difference between passing or failing an inspection – and you also will limit your long term liability for the job.

We created the **Wheel of Accountability** as a simple way to illustrate these relationships as they apply to rooftop structures and waterproofing. At the center of our Wheel, the AHJ (Authority Having Jurisdiction) is typically the local building inspector. The AHJ ultimately interprets the building codes and best standards and practices as agreed upon and published by the agencies listed along the circumference of the Wheel.

SMACNA, NRCA and ARMA help provide time-tested, best-practice guidelines for roofing buildings and other enclosed structures. The guidelines are published by the IBC, IRC, SBC and NFPA, and also in manuals compiled by the individual trade groups. These manuals are available for purchase in many places on the web.

ICC and UL provide quality standards and testing methods for product manufacturing compliance.

OSHA focuses exclusively on workplace safety and can shut down any job site and fine an installer for unsafe workplace practices. The building inspector (AHJ) can act as the arm of OSHA, and in fact can act on behalf of any one of the parties listed on the Wheel.

The roofing manufacturer is a key figure in our Wheel of Accountability because their installation instructions must be followed to the letter to prevent voiding the roof warranty and to limit long term exposure to the owner and contractor.

See quickmountpv.com for detailed descriptions of these key players and relevant building codes.

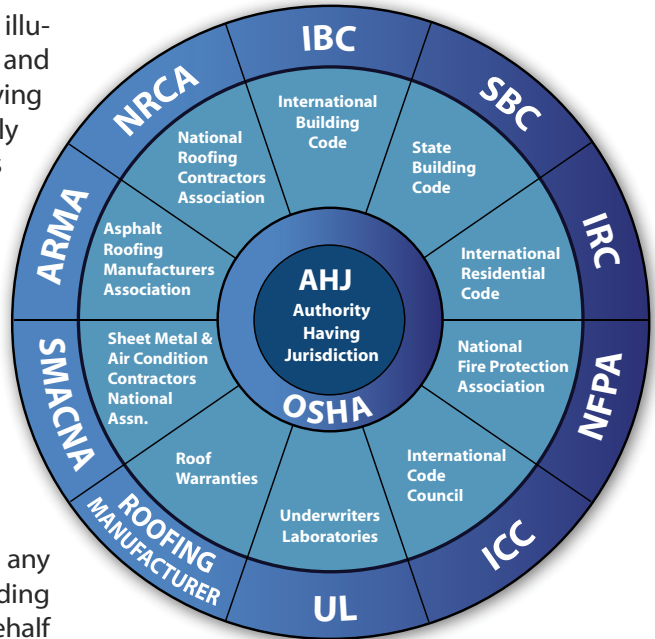

WHEEL OF ACCOUNTABILITY

Training, Service & Support

Quick Mount PV products are sold exclusively through our national network of distributors, and we are happy to offer training and support to their customers – the solar installers, roofers, electricians, HVAC technicians and other professionals who are on the roof installing systems with Quick Mounts.

Year-Round Training Opportunities

Quick Mount PV is committed to training solar installers throughout North America to bring the highest quality mounting systems to the roof. We offer product and installation training classes in many places and venues from trade shows and distributor events to hands-on training sites as well as free monthly webinars. Our classes qualify for NABCEP Continuing Education Credits for NABCEP-certified installers. Email training@quickmountpv.com or visit quickmountpv.com for a list of upcoming training opportunities and webinars.

Responsive Customer Service

When you call Quick Mount PV during business hours, you'll get a real person to talk to. We do our very best to respond to all inquiries, emails and requests within 24 hours.

Live Tech Support

Contact Tech Support between 8 AM and 4:30 PM, Pacific Time, Monday through Friday. You can also email tech@quickmountpv.com with your questions.



IMPORTANT: Properly flashing penetrations on PVC, TPO and other membrane roofs requires the use of manufacturer-specified flashing material to ensure safe chemical interaction with the specific type of membrane roof. Always use the services of a certified roofer when installing PV on a membrane roof.

THE RECOGNIZED INDUSTRY STANDARD

- Fastest to install
- Easiest to use
- Unmatched strength
- 100% code compliant
- Commercial & residential solutions
- All hardware included
- 50-year life cycle

Memberships & affiliations:

SEIA, NRCA, ANSI, ASES, ICC, SEPA, NORCAL SOLAR,
CALSEIA, BAY AREA GREEN BUSINESS, RISE, NFPA, NABCEP, WSRCA,
CENTER FOR ENVIRONMENTAL INNOVATION IN ROOFING

PHOTO CREDITS:

Sungevity - top photo, cover
Fidelity Roof Company - bottom photo, cover; top photo, p4
National Solar Inc. - top photo, p3
Scurfield Solar - solar hot water photo, p3
Creative Energies - inside cover, top photo, p5

Distributed by:



(925) 687-6686

2700 Mitchell Dr., Bldg 2

Walnut Creek, CA 94598

sales@quickmountpv.com

www.quickmountpv.com

